

WESLEY COE (CAMBRIDGE) LIMITED

SCOTLAND ROAD, CAMBRIDGE.

MATERIAL-	THIRD ANGLE PROJECTION	ITEM No.	PART No.	No. OFF
SIZE-		EN2HARD	F123	1
TO SPEC. D5784 ISS.3		48% NiFe	P179	9
		M.E.3.	M1001/4	9

DIMENSIONS IN M.MS.
INCHES IN BRACKETS

DIMENSIONS BEFORE FINISH

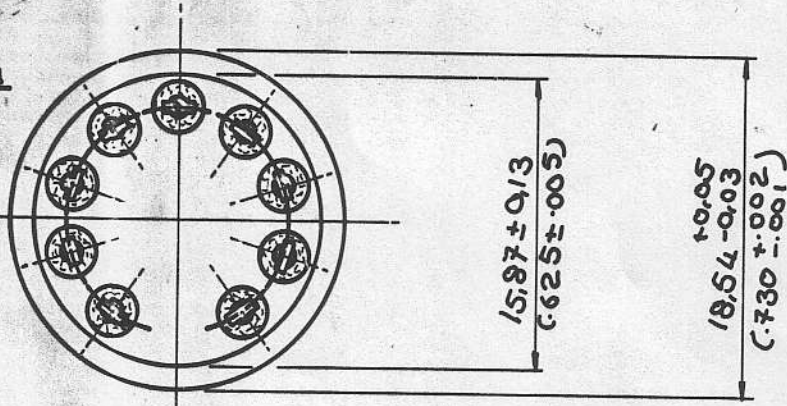

9 PINS 1.02 ± 0.03 DIA.
(0.040 ± 0.001)
SPACED AT 36° ON A
11.89 ± 0.05 (0.468 ± 0.002)
P.C.D. FLATS ON PINS TO
BE TANGENTIAL TO P.C.D.
AS SHOWN.

JIG AS DRAWN

GLASS 0.25 (0.010)
SUB-FLUSH TO 0.25
(0.010) MAX. CLMA
THIS SIDE.

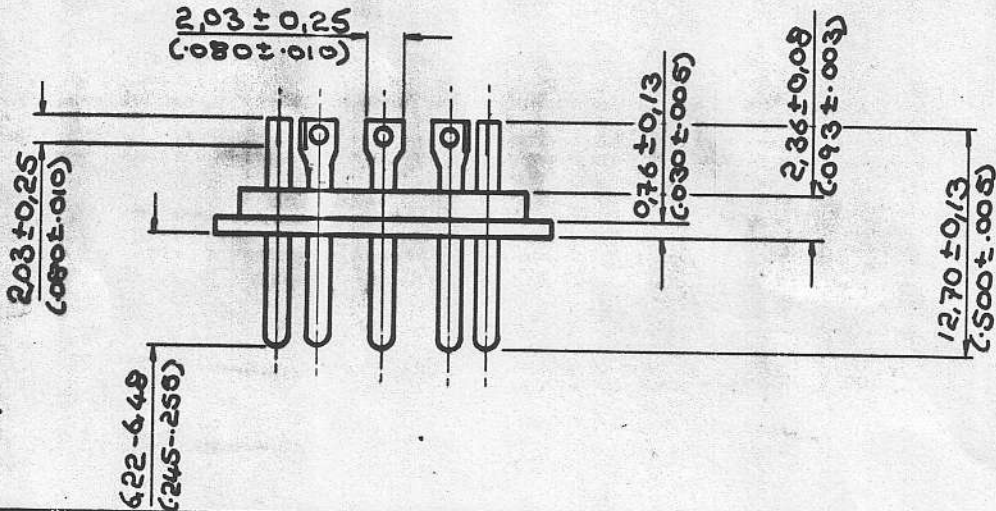

GLASS FLUSH TO
0.25 (0.010) SUB-
FLUSH THIS SIDE.

ALL OPERATIONS TO HAVE FIRST OFF INSPECTION

1	WITHDRAW & CHECK PIECE PARTS	12	FINAL PLATE	SEE TABLE
2	DEGAS ALL PARTS	13	PLATING CHECK	QA-1P/11L
3	PRE-NICKEL FERRULE	14	ELECTRICAL	1.5 KV. QA-1P/9
4	NICKEL TEST	15	INSULATION TEST	10000 Hn @ 500V.
5	RETURN TO STORES	16	PRESSURE TEST	30 P.S.I. ON 5%
6	ISSUE TO SHOP	17	FINAL INSPECTION	QA-1P/13
7	CHECK PIECE PARTS	18		
8	LOAD JIGS	19	J. NO.	FINISH
9	KILN LOAD S2/9	20	D5784A	(HOT TIN DIP) MF2/18
10	END OF KILN	21	D5784B	0.002-0.003 ELECTROLESS NICKEL ALL OVER. 0.002-0.004 CLUM TIN FERRULE ONLY
11	FINAL VIEW QA-1P/3	22	D5784C	ELECTROLESS NICKEL

REDUCTION FROM ISSUE CHANGES

1	9.5.68	CARBON JIG No.	CUSTOMER AND DRG. No.	STANDARD
2	8.4.71 D/0646	D215 A.6	DRAWN 9.5.73	
3	16.1.73 D/01306	TOOL No.	CHK.	
			SCALE 3:1	D5784

MY 12350R

W1943